



Sportsacademy Sofa The continue of the project

1. Contents

A plot of land for economic grounds is/has to be acquired and to be built upon. The earnings will sustain/provide for the project, salaries, leases and future construction costs that result from the extension of schooling and training facilities.

The first step is to establish and construct our own sporting grounds on the smallest possible scale on the site to keep the costs low. This guarantees that the project is self-sufficient by avoiding follow-up costs and dependencies.

Subsequently a school will be set up to educate and train students according to European standards. The main focus is directed to the creative development through sports and music based on a holistic approach to education.

A rented building in the city of Dakar accommodates the office headquarters of the sports academy for coordination, planning and implementation on site. From these headquarters the communication with the Viennese site, which handles the subordinate coordination and control of the projects procedures in Senegal, takes place.

First estimates are listed below:

- **Property and Building**

265.300 EUR

- **Office rent in Dakar, Senegal**

400 EUR

a deposit of 3 months rent is to be paid beforehand

Total costs for 2 years: 10.800 EUR

- **Launch and Duration**

implementing each phase will take about a year to establish the procedures.

- **Quality Assurance**

We examine and evaluate the headway of the project constantly and publish any progress via our Social Media channels, serving as our news portals and via our homepage in the news section.

These news include written articles as well as photos and other forms of media coverage.

- **Sustainability**

after being completed the project is not bound to any duration and should also support and sustain other projects. Accordingly the project is designed to be self-sufficient and proceed further without external promotion.

1. Phase 1: Construction

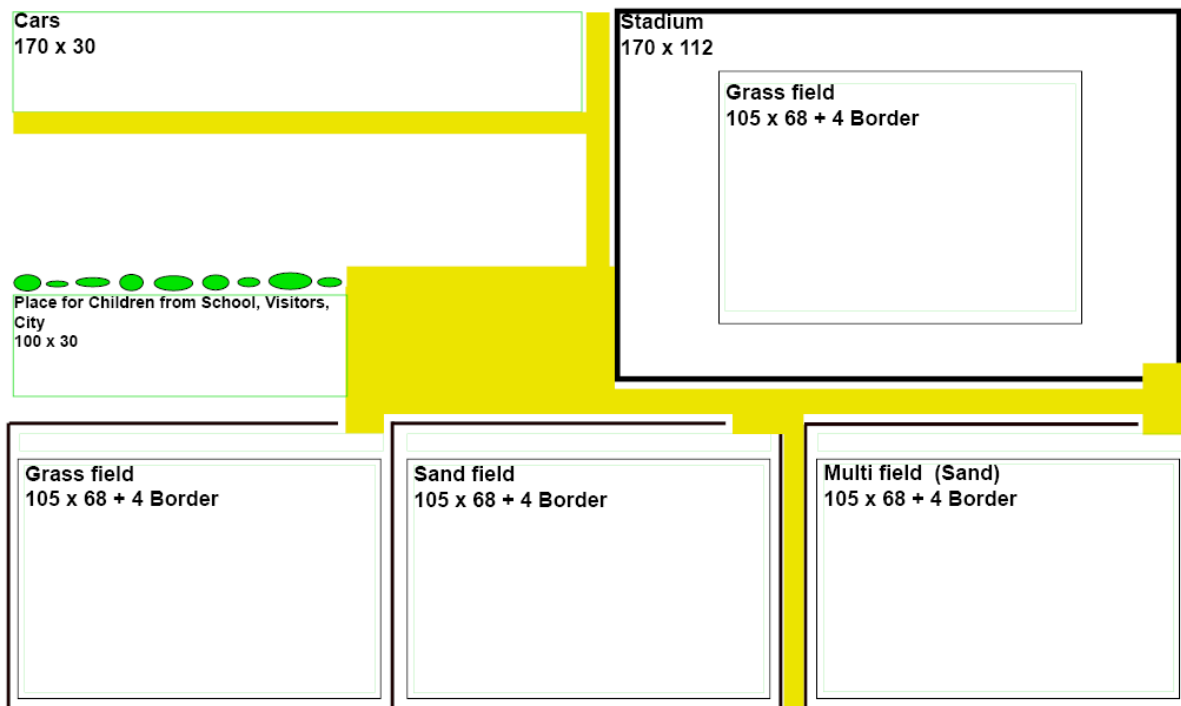

A car parking space on a clay court and a park like place, for the students, visitors and other training possibilities will be located around the designated sporting grounds.

The sporting grounds will have different flooring. There will be two sand fields, one for football one as a multi-purpose field. The others will have an artificial turf.

One of the artificial turfs will be surrounded by a stadium which step by step will be equipped by small rostrums with easy extendibility to keep the initial costs at a minimum level. The changing rooms as well as the showers and toilet facilities for the whole area will be located in the stadium.

The completion of this phase ensures the commissioning of the grounds so that dependencies on other organizations can be avoided. Renting out each of the fields to other clubs and organizations while they are not being used will cover running/ongoing expenditures.

Thereby trainings and championship matches can be held and played without exposing the athletes and participants to serious health hazards and other potential obstacles.

Sporting Grounds

1 Sand field for training and championship matches 105 x 68 7.500m²

1 Sand field for training and other sports 105 x 68 7.500m²

1 artificial turf training and championship matches 105 x 68 7.500m²

Stadium

Stadium with changing rooms, shower and toilet facilities 170 x 112 19.040m²

(of which the artificial turf takes up 7.500m²)

Overall size of phase 1 area

300m² width x 350m² length

10,5 hectare

Estimates

Fences 10.000 EUR

Property costs 65.000 EUR

Salary for an employee for 2 years (400 EUR per month) 10.000 EUR

Salary for project implementation, to be paid once (4 persons) 48.000 EUR

Overall costs project phase 1

133.000 EUR

Possible local partnerships would be beneficial to accumulating acquisition costs.



3. Phase 2: Expansion – School and Economic Goods

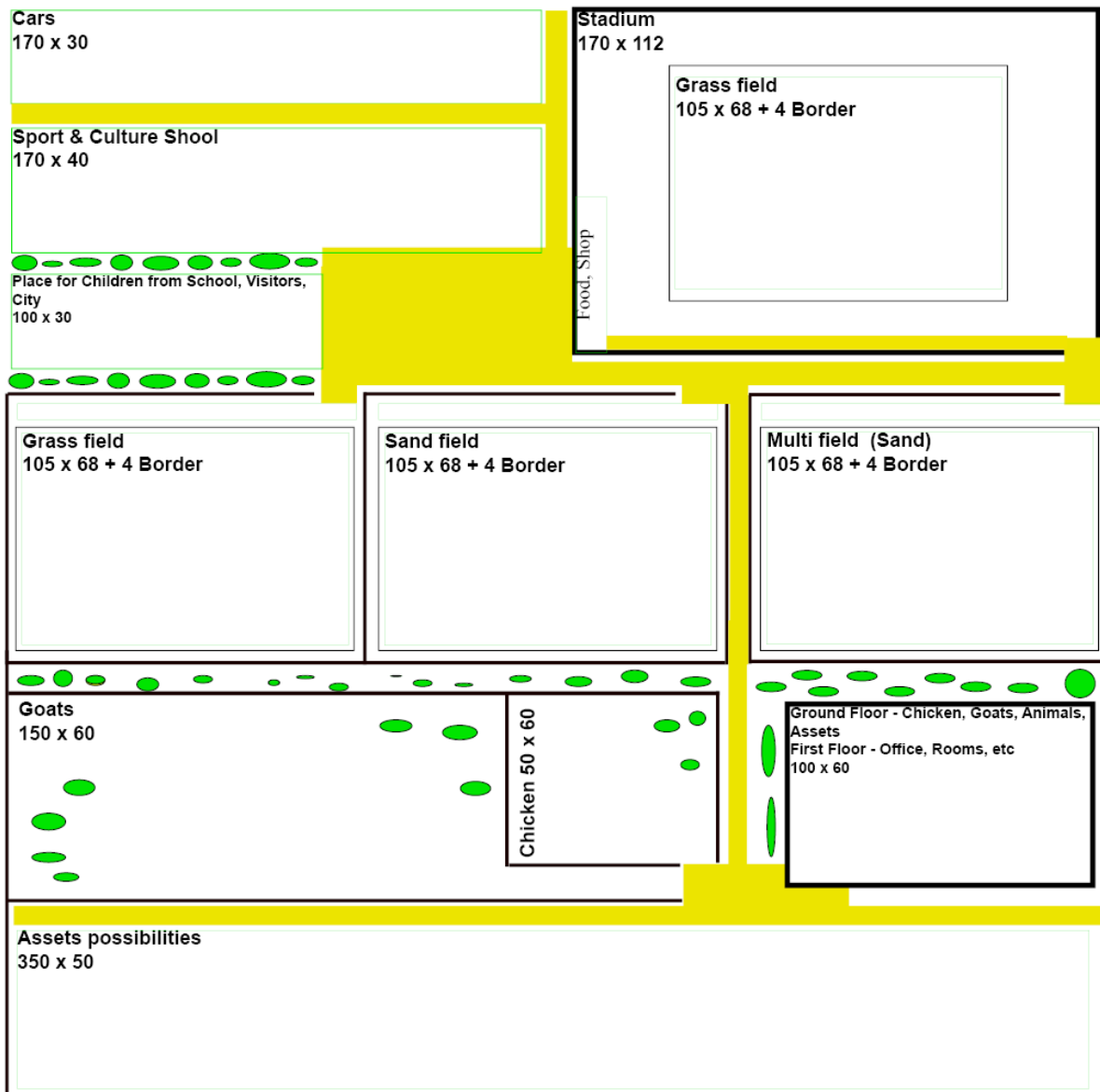

The area will be expanded reaching below the sporting grounds. This will also entail the fencing in of the whole site. Besides the possibility of growing agricultural crops, breeding grounds for sheep and chickens for stock farming are planned.

All of this will be accomodated and stored in a seperately built, two-storey house. It also serves as quarters for players, employees of the site and for other guests, enabling futher possibilities of utilization.

The school, located next to the stadium, will cooperate with each area of the site for sports training, muscial education and economic cultivation.

Economic sector for maintaining the project

22.500m² area für sheep, to preserve the *Ladoum* breed 250 x 90
16.000m² area for breeding (approximately 500 chickens) 200 x 80
A well with a depth of 10m as a water supply

Two-storey building 200x90

1. Storey lodging for goats, sheep, chickens
2. Storey quarters for employees, players and economic goods

School 170x40

1. Storey classrooms
- Planned 2. storey with sleeping quarters

Overall of phase 2 area

300m² width x 750m² length
20,25 hectare

Solar panles

for power supply and to operate the water supply

Estimates

<i>Fences</i>	10.000 EUR
Spring	5.000 EUR
Building 2 storeys	80.000 EUR
School 1 storey	60.000 EUR
Animals	1.000 EUR
Property costs	65.000 EUR
Solar panels	20.000 EUR

Salary for 8 employees for 2 years (400 EUR per month) 76.800 EUR

Salary for project implementation, to be paid once (4 persons) 48.000 EUR

Overall costs project phase 1

192.300 EUR

Possible local partnerships would be beneficial to accumulating acquisition costs.